

HUB 425KG WHELLOAD WATERPROOF AXLE 700/850KG

ETI- No. 811323

(Specify the order with the ETI No.)

AL-KO
Spare Parts

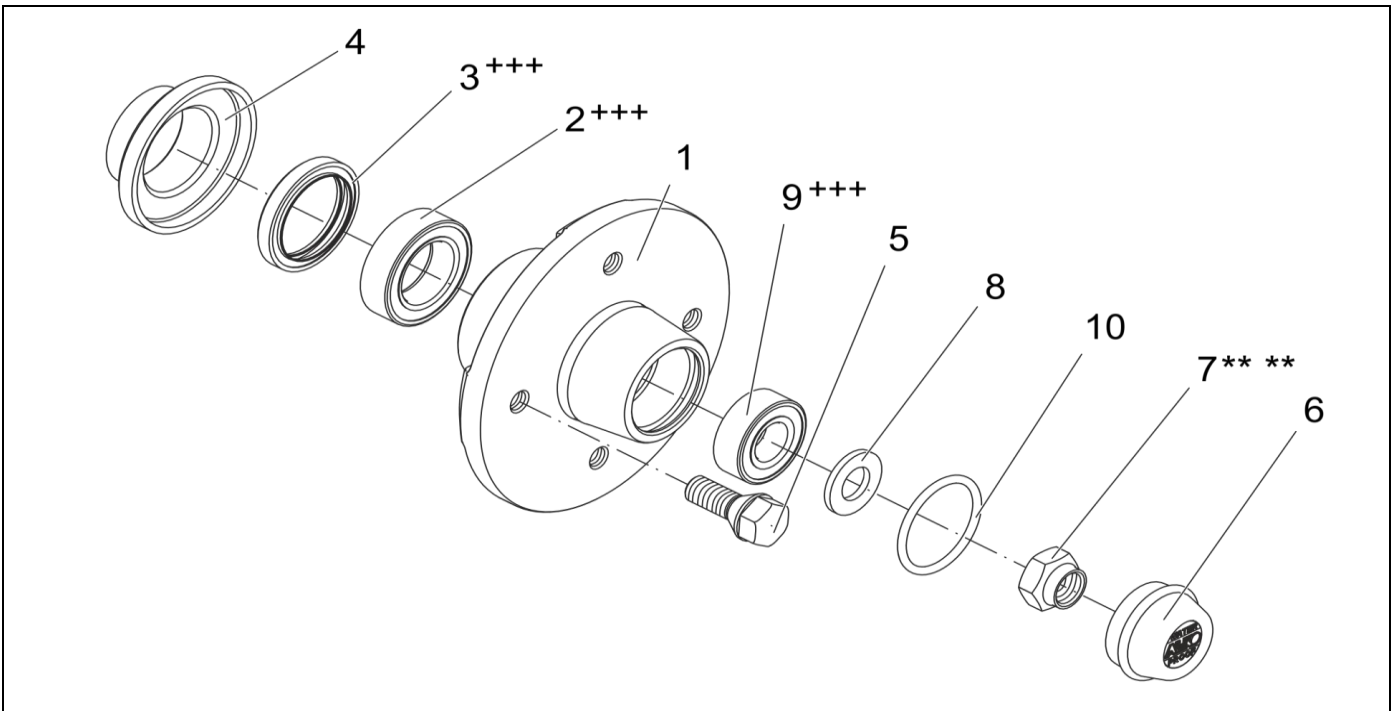

Item	Description	Part No.	
1	HUB COMPLETE WITH BEARINGS		
	Ø100X4 M10X1.25	1369680	
	Ø100X4 M12X1.5	1369679	
	Ø101.6X4 M10X1.25	1369681	
	Ø101.6X4 M12X1.5	1369682	
	Ø112X5 M12X1.5	1369678	
2	ROLLER BEARING LM45449/410	+++	701513
3	RADIAL SHAFT SEAL DIN3760-AS 40X52X7-NBR	+++	1312430
4	IMPACT PROTECTION Ø40		1312431
5	WHEEL BOLT	CONUS M12X1.5	2081670018
		SPHERIC M12x1.5	2081670020
6	END CAP WATER RESISTANT Ø40		1335088
7	SELF LOCKING NUT (NON-STANDARD)	** **	1312008
8	WASHER DIN125-A17-A3C		700625
9	ROLLER BEARING LM11749/710	+++	701512
10	O-RING DIN 3771-40X3.5-NBR70		704458

+++ PLEASE USE MULTI-PURPOSE GREASE ACCORDING TO DIN 51825 KTA 3K FOR GREASING THE BEARING AND RADIAL SEALING

** ** FOR SAFETY REASONS: SELF-LOCKING NUT AND SCREW WITH CHEMICAL SELF-LOCKING MUST BE USED ONCE.
AFTER UNTIGHTEN ALWAYS USE A NEW SPARE.

provided	ETI-No.	changed	Change No.	Reason of the change	Revisions-No.
25.09.00	811323_en	03.02.2011 BB	FREIGABE		A