

BALL COUPLINGS

Ball Couplings are used for various applications. Our extensive range of products and features provide a wide selection of options. To identify the correct product for your application, the following symbols specify product group, additional uses and characteristics.

- Electropolished**
Standard corrosion protection
- Soft touch grip**
Prevents hands from slipping
- Coupling indicator**
Indicator for correct coupling
- Wear indicator**
Wear indicator for the low ball

- No unsuccessful coupling**
Protects against unsuccessful coupling
- Anti-Snaking**
Cushions snaking movements
- Anti-pitching**
Cushions pitching movements
- Wear indicator**
Wear indicator for the friction linings

- Maximum speed**
more theoretical maximum speed
- Soft dock option**
Protects the shin and rear of the vehicle
- Lock option**
Anti-theft device against rapid unauthorised access

BALL COUPLINGS

Ball coupling WW 8 steel up to 800 kg

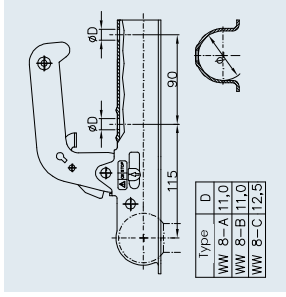

ECE R55-No.
56R-012211 E1

Order no.	Drawer diam.	Trailer load	Nose load	Ball diam.	D/Dc value											
WW 8-A 1860730 (W 1018)	50 mm	800 kg	75 kg	50 mm	7,7 kN	400	400	400	400	12						
WW 8-A+HAL 1860731 (W 1019)	50 mm	800 kg	75 kg	50 mm	7,7 kN	1,25 kg	400	400	400	12						
WW 8-B 1860732 (W 1020)	60 mm	800 kg	75 kg	50 mm	7,7 kN	400	400	400	400	12						
WW 8-B+HAL 1860733 (W 1021)	60 mm	800 kg	75 kg	50 mm	7,7 kN	1,24 kg	400	400	400	12						
WW 8-C 1860734 (W 1022)	70 mm	800 kg	75 kg	50 mm	7,7 kN	1,24 kg	400	400	400	12						
WW 8-C+HAL 1860735 (W 1023)	70 mm	800 kg	75 kg	50 mm	7,7 kN	1,26 kg	400	400	400	12						

BASIC PRODUCT LINE

BASIC products are solid and robust. These products have been developed to offer the basic functional operation required by trailer users and will be suitable for a wide range of applications.

We ensure that these Basic variants also meet our high quality standards and exceed the legal minimum requirements.

PLUS PRODUCT LINE

The products in the **Plus** category boast high quality materials, finishing and reliability to ensure long service life. Their high level of stability and smart technical features fulfill the high requirements in the day to day use of trailers.

All products have a greater range of functions and are very user-friendly and appealing in their design.

PREMIUM PROFI PRODUCT LINE

Premium Profi products offer industry leading design, sophisticated functions and the highest manufacturing quality. They are innovative and traditional products designed to withstand the highest demands and challenging areas

of application. They are gold standard in terms of functions, material and design and offer the longest service life ensuring many years of use in the harshest environments.

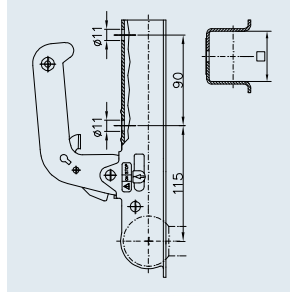
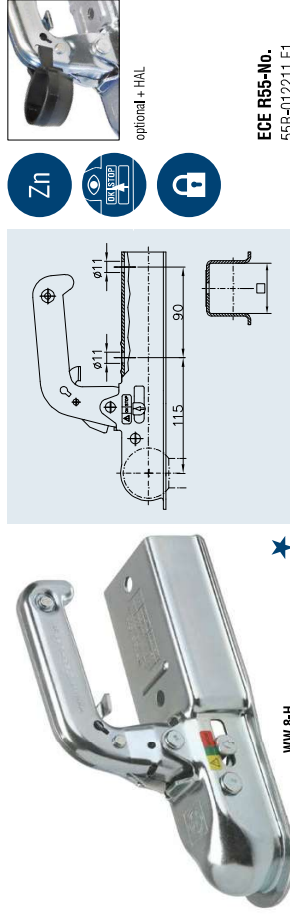

ECE R55-No.
56R-012211 E1

Order no.	Drawer diam.	Trailer load	Nose load	Ball diam.	D/Dc value											
WW 8-D30 1860736 (W 1024)	30 mm	800 kg	75 kg	50 mm	7,7 kN	1,27 kg	400	400	400	12						
WW 8-D40 1860737 (W 1026)	40 mm	800 kg	75 kg	50 mm	7,7 kN	1,27 kg	400	400	400	12						
WW 8-D45+HAL 1860739 (W 1029)	45 mm	800 kg	75 kg	50 mm	7,7 kN	1,29 kg	400	400	400	12						
WW 8-E 1860740 (W 1030)	50 mm	800 kg	75 kg	50 mm	7,7 kN	1,25 kg	400	400	400	12						
WW 8-E+HAL 1860741 (W 1031)	50 mm	800 kg	75 kg	50 mm	7,7 kN	1,27 kg	400	400	400	12						
WW 8-G 1860742 (W 1032)	60 mm	800 kg	75 kg	50 mm	7,7 kN	1,27 kg	400	400	400	12						
WW 8-G+HAL 1860743 (W 1033)	60 mm	800 kg	75 kg	50 mm	7,7 kN	1,29 kg	400	400	400	12						
WW 8-H 1860744 (W 1034)	70 mm	800 kg	75 kg	50 mm	7,7 kN	1,31 kg	400	400	400	12						
WW 8-H+HAL 1860745 (W 1035)	70 mm	800 kg	75 kg	50 mm	7,7 kN	1,33 kg	400	400	400	12						

BALL COUPLINGS

Ball coupling WW 8 steel up to 800 kg

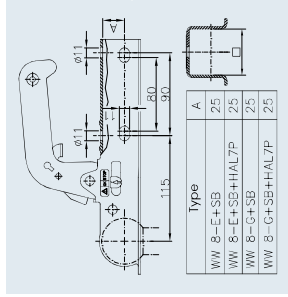

optional + HAL

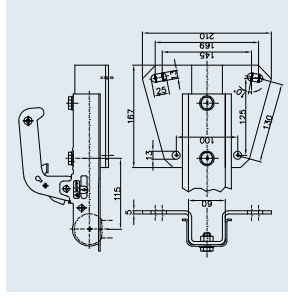

ECE R55-No.
56R-012211 E1

WW 8-E+S8

Order no.	Drawbar diam.	Trailer load	Nose load	Ball diam.	D/Dc value	Zn	ECE R55	Lock
1860748 (W 1039)	50 mm	800 kg	75 kg	50 mm	7,7 kN	1,25 kg	400	400
1860749 (W 1041)	50 mm	800 kg	75 kg	50 mm	7,7 kN	1,27 kg	400	400
1860747 (W 1038)	60 mm	800 kg	75 kg	50 mm	7,7 kN	1,27 kg	400	400
1860746 (W 1037)	60 mm	800 kg	75 kg	50 mm	7,7 kN	1,29 kg	400	400

Ball coupling WW 8 with V-adapter up to 800 kg

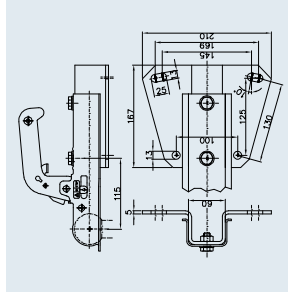

optional + HAL



ECE R55-No.
56R-012211 E1

Order no.	Drawbar	Trailer load	Nose load	Ball diam.	D/Dc value	Zn	ECE R55	Lock
1860752 (W 1050)	V-drawbar	800 kg	75 kg	50 mm	7,7 kN	3,05 kg	-	200

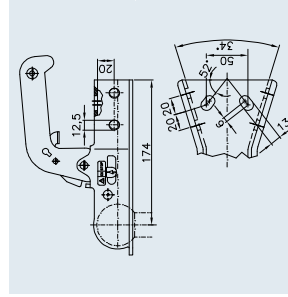

incl. + HAL



ECE R55-No.
56R-012211 E1

Order no.	Drawbar	Trailer load	Nose load	Ball diam.	D/Dc value	Zn	ECE R55	Lock
1860750 (W 1044)	V-drawbar	800 kg	75 kg	50 mm	7,7 kN	1,49 kg	400	400

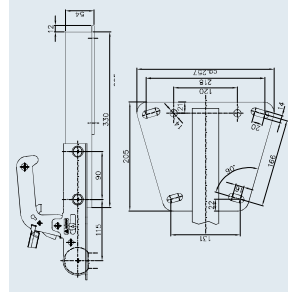

incl. + HAL



ECE R55-No.
56R-012211 E1

Order no.	Drawbar	Trailer load	Nose load	Ball diam.	D/Dc value	Zn	ECE R55	Lock
1860751 (W 1055)	V-drawbar	800 kg	75 kg	50 mm	7,7 kN	3,78 kg	-	100

BALL COUPLINGS

Ball coupling WW 150 with V-adapter up to 1,500 kg

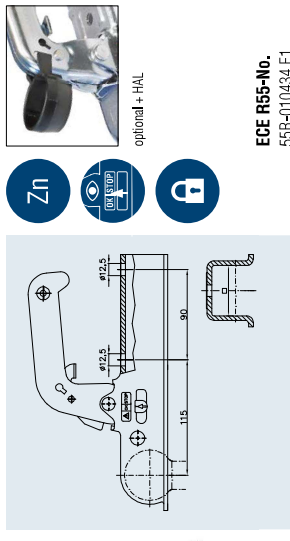
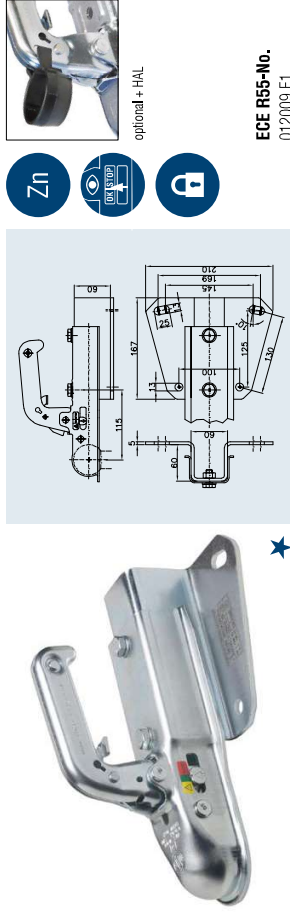

Ball coupling WW 150 steel up to 1,500 kg

ECE R55-No.
012009 E1

ECE R55-No.
55R-010434 E1

Order no.	Drawbar	Trailer load	Nose load	Ball diam.	D/Dc value	Icons			
1860764 (W 1167)	V-drawbar	1,500 kg	100 kg	50 mm	14,1 kN	3,778 kg	-	200	12

Order no.	Drawbar diam.	Trailer load	Nose load	Ball diam.	D/Dc value	Icons			
WW 150-VF-HAL 1860762 (W 1165)	60 mm	1,500 kg	100 kg	50 mm	14,1 kN	1,74 kg	-	400	12
WW 150-VF 1860763 (W 1166)	60 mm	1,500 kg	100 kg	50 mm	14,1 kN	1,74 kg	-	400	12
WW 150-VG 1860765 (W 1168)	70 mm	1,500 kg	100 kg	50 mm	14,1 kN	1,74 kg	-	400	12
WW 150-VG+HAL 1860766 (W 1169)	70 mm	1,500 kg	100 kg	50 mm	14,1 kN	1,74 kg	-	400	12

Ball coupling WW 150 steel up to 1,500 kg

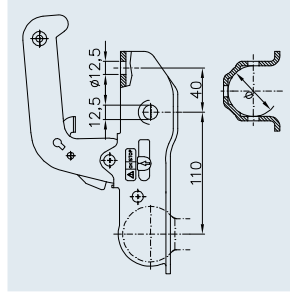
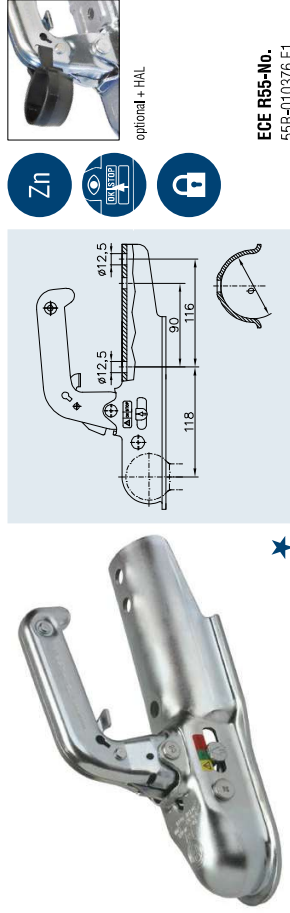

Ball coupling WW 13 – WW 150 steel up to 1,500 kg

ECE R55-No.
55R-010376 E1

Order no.	Drawbar diam.	Trailer load	Nose load	Ball diam.	D/Dc value	Icons			
WW 150-R6 1860761 (W 1164)	70 mm	1,500 kg	100 kg	50 mm	14,1 kN	1,69 kg	-	400	12

Order no.	Drawbar diam.	Trailer load	Nose load	Ball diam.	D/Dc value	Icons			
WW 13-N ¹⁾ 1860759 (W 1100)	45–46 mm	1,500 kg	100 kg	50 mm	14,1 kN	1,36 kg	-	400	12
WW 150-RB ²⁾ 1860760 (W 1162)	50–51 mm	1,500 kg	100 kg	50 mm	14,1 kN	1,41 kg	-	400	12

¹⁾ ECE R55-No. 55R-010366 E1

²⁾ ECE R55-No. 55R-010376 E1

BALL COUPLINGS

Ball coupling WW 220 steel up to 2,200 kg

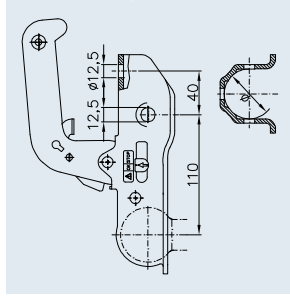

ECE R55-No.
56R-010399 E1

WW 220-RA

Order no.	Drawer diam.	Trailer load	Nose load	Ball diam.	D/Dc value	Trailer load	Nose load	Ball diam.	D/Dc value
1861584 (W 1170)	45-46 mm	2,200 kg	100 kg	50 mm	20,2 kN	1,77 kg	1,77 kg	-	400
1861585 (W 1172)	50-51 mm	2,200 kg	100 kg	50 mm	20,2 kN	1,77 kg	1,77 kg	-	400

Ball coupling WW 20 cast iron up to 2,000 kg

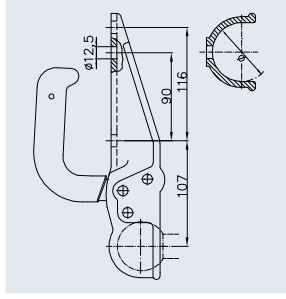

ECE R55-No.
56R-012251 E1

WW 20-F2

Order no.	Drawer diam.	Trailer load	Nose load	Ball diam.	D/Dc value	Trailer load	Nose load	Ball diam.	D/Dc value
1860789 (W 1070)	50 mm	2,000 kg	100 kg	50 mm	18,5 kN	1,69 kg	1,69 kg	350	300
1860790 (W 1074)	60 mm	2,000 kg	100 kg	50 mm	18,5 kN	1,69 kg	1,69 kg	350	300
1860791 (W 1076)	70 mm	2,000 kg	100 kg	50 mm	18,5 kN	1,69 kg	1,69 kg	350	300

Ball coupling WW 200 cast iron up to 3,000 kg

Hole for commercial padlock

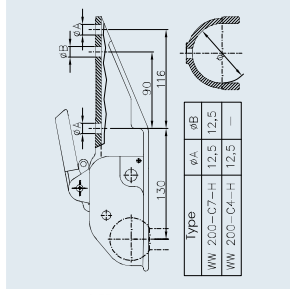

ECE R55-No.
56R-010338 E1

WW 200-C7-H

Order no.	Drawer diam.	Trailer load	Nose load	Ball diam.	D/Dc value	Trailer load	Nose load	Ball diam.	D/Dc value
1860792 (W 1082)	70 mm	3,000 kg	150 kg	50 mm	27,0 kN	3,38 kg	3,38 kg	300	250
1860793 (W 1086)	80 mm	3,000 kg	150 kg	50 mm	27,0 kN	3,65 kg	3,65 kg	300	250

Hole for commercial padlock

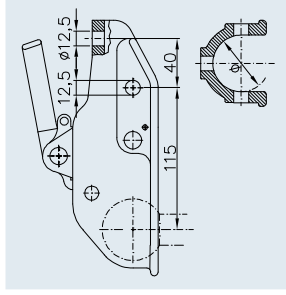

ECE R55-No.
56R-010338 E1

WW 200-83-H

Order no.	Drawer diam.	Trailer load	Nose load	Ball diam.	D/Dc value	Trailer load	Nose load	Ball diam.	D/Dc value
1860812 (W 1260)	45-46 mm	3,000 kg	150 kg	50 mm	27,0 kN	2,98 kg	2,98 kg	350	300
1860813 (W 1270)	50-51 mm	3,000 kg	150 kg	50 mm	27,0 kN	3,24 kg	3,24 kg	350	300

BALL COUPLINGS

Ball coupling WW 30 cast iron up to 3,000 kg



WW 30-D2

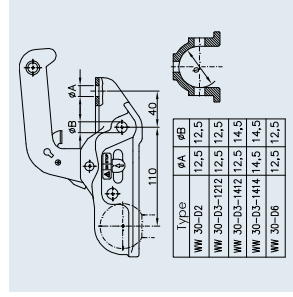

ECE R55-No.
56R-010840 E1

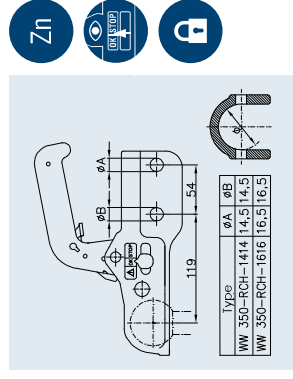

WW 350-RCH

ECE R55-No.
56R-010380 E1

Order no.	Drawer diam.	Trailer load	Nose load	Ball diam.	D/Dc value			
1860795 (W 1135)	45-46 mm	3,000 kg	150 kg	50 mm	27,0 kN	2,36 kg	-	400 12
WW 30-D2								
WW 30-D3-1212	50-51 mm	3,000 kg	150 kg	50 mm	27,0 kN	2,38 kg	-	400 12
WW 30-D3-1412	50-51 mm	3,000 kg	150 kg	50 mm	27,0 kN	2,38 kg	-	400 12
WW 30-D3-1616	50-51 mm	3,000 kg	150 kg	50 mm	27,0 kN	2,38 kg	-	400 12
1860802 (W 1148)	60 mm	3,000 kg	150 kg	50 mm	27,0 kN	2,42 kg	-	400 12

Order no.	Drawer diam.	Trailer load	Nose load	Ball diam.	D/Dc value			
WW 350-RCH-1414	60 mm	3,500 kg	200 kg	50 mm	31,0 kN	3,70 kg	-	400 12
WW 350-RCH-1616	60 mm	3,500 kg	200 kg	50 mm	31,0 kN	3,70 kg	-	400 12

Ball coupling WW 350 cast iron up to 3,500 kg



WW 350-RB

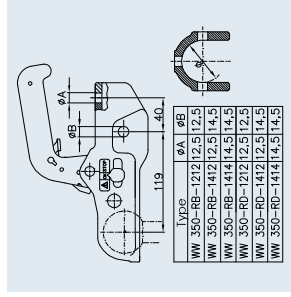

ECE R55-No.
56R-010380 E1

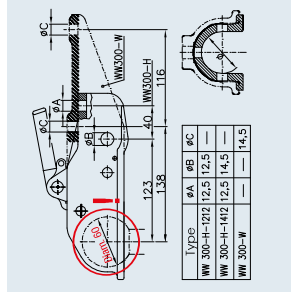

WW 300-H

ECE R55-No.
56R-011242 E1

Order no.	Drawer diam.	Trailer load	Nose load	Ball diam.	D/Dc value			
WW 350-RB-1212	50 mm	3,500 kg	200 kg	50 mm	31,0 kN	3,40 kg	-	400 12
1860803 (W 1180)								
WW 350-RB-1412	50 mm	3,500 kg	200 kg	50 mm	31,0 kN	3,40 kg	-	400 12
1860804 (W 1181)								
WW 350-RB-1616	50 mm	3,500 kg	200 kg	50 mm	31,0 kN	3,40 kg	-	400 12
1860805 (W 1182)								
WW 350-RD-1212	65 mm	3,500 kg	200 kg	50 mm	31,0 kN	3,54 kg	-	400 12
1860806 (W 1184)								
WW 350-RD-1412	65 mm	3,500 kg	200 kg	50 mm	31,0 kN	3,54 kg	-	400 12
1860807 (W 1185)								
WW 350-RD-1616	65 mm	3,500 kg	200 kg	50 mm	31,0 kN	3,54 kg	-	400 12
1860808 (W 1186)								

Order no.	Drawer diam.	Trailer load	Nose load	Ball diam.	D/Dc value			
WW 300-H-1212-D60 BALL	50 mm	3,500 kg	150 kg	60 mm	31,0 kN	3,48 kg	350	300 12
1860815 (W 1411)								
WW 300-H-1412-D60 BALL	50 mm	3,500 kg	150 kg	60 mm	31,0 kN	3,48 kg	350	300 12
1860816 (W 1412)								
WW 300-W-D60 BALL	70 mm	3,500 kg	150 kg	60 mm	31,0 kN	3,52 kg	350	300 12

Hole for commercial padlock

Important!

Special ball coupling only suitable for 60 mm diam. low balls. This ball coupling should not be used with standard 50 mm diam. low balls.

BALL COUPLINGS

Universal Ball coupling WW 30-K+Z cast iron up to 3,000 kg

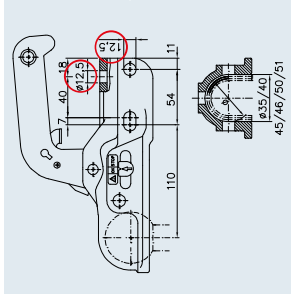

★
ECE R55-No.
5GR-010840 E1

Order no.	Drawbar diam.	Trailer load	Nose load	Ball diam.	D/Dc value	3,60 kg	170	12
WW 30-K+Z 1860801 (W 1146)	35-40-45-46-50-51 mm	3,000 kg	150 kg	50 mm	27,0 kN			



BALL COUPLING

Stabiliser coupling with anti snaking WS 3000 / WS 3500



WS 3000 = 3,000 kg

WS 3500 = 3,500 kg

Specially developed friction linings are pressed against the tow ball of the vehicle under high pressure to generate additional stability of the car and trailer combination. The stabiliser coupling assists by increasing the critical driving speed, the point at which the car and trailer becomes unstable, by up to 80%. All WS 3000 / WS 3000 / WS 3500 stabiliser couplings fulfill the ISO 11555-1 standard and are therefore approved stabilising units for the 100 km/h regulation.



Single coupling function



Coupling indicator



Wear indicator

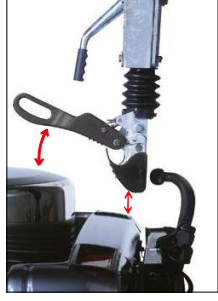

More free space to the rear of the vehicle



Unrestricted tow ball neck clearance



Maxi soft dock

BALL COUPLING

Stabiliser coupling with anti snaking WS 3000 / WS 3500



★ ★ ★

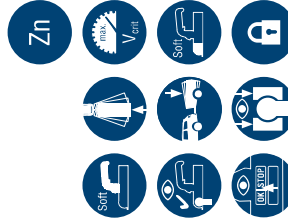
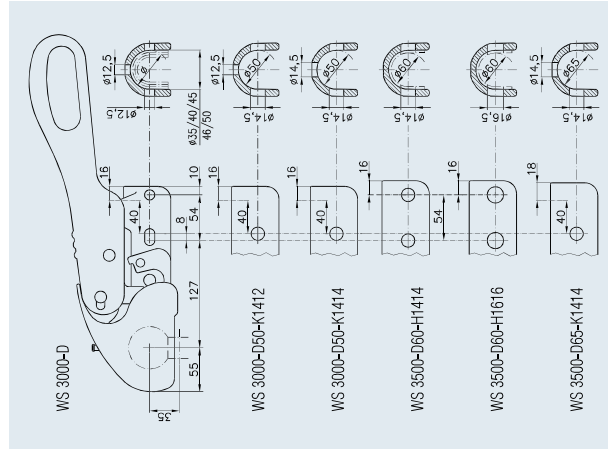

WS 3000 = 3,000 kg

WS 3500 = 3,500 kg

Order no.	Drawbar diam.	Trailer load	Nose load	Ball diam.	D/Dc value
1860848 (W 1450)	35-40-45-46-50 mm	3,000 kg	150 kg	50 mm	27,0 KN
1860849 (W 1451)	50 mm	3,000 kg	150 kg	50 mm	27,0 KN
1860853 (W 1456)	50 mm	3,000 kg	150 kg	50 mm	27,0 KN
1860856 (W 1460)	60 mm	3,500 kg	150 kg	50 mm	31,0 KN
1860857 (W 1462)	60 mm	3,500 kg	150 kg	50 mm	31,0 KN
1860859 (W 1464)	65 mm	3,500 kg	150 kg	50 mm	31,0 KN

¹ ECE R65-Nr. 556-01/0065 E1

² ECE R65-Nr. 556-01/941 E1

Stabiliser coupling with anti snaking WS 3000 / WS 3500



WS 3000-D-Z

★ ★ ★



BALL COUPLINGS - ACCESSORIES

Anti-theft devices for WS 3000 / WS 3500



	Order no.	suitable for				
ROBSTOP WS 3000	1860170 (W1551)	WS 3000 from construction years 08-2002	1,48 kg	-	500	12
SAFETY PACK WS	1860847 (W1448)	WS 3000 from construction years 08-2002	7,19 kg	-	60	12



	Order no.	suitable for	Certificates			
ROBSTOP WS 3000 PLUS	1860171 (W1553)	WS 3000 from construction years 08-2002	SoftSecure Gold (GB), SCM (NL)	1,92 kg	-	500
ROBSTOP WS 3000 PLUS-S	1860164 (W1525)	WS 3000 from construction years 08-2002	SBSC (S)	2,03 kg	-	500
SAFETY PACK WS PLUS	1861416 (W1449)	WS 3000 from construction years 08-2002	SoftSecure Gold (GB), SCM (NL)	7,653 kg	-	60
ROBSTOP WS 3500 PLUS	1860169 (W1545)	WS 3500	SoftSecure Gold (GB), SCM (NL)	2,37 kg	-	400

Anti theft devices for ball couplings



	Order no.	suitable for				
SAFETY-BOX-K	1860174 (W5012)	universal	2,16 kg	-	150	12
SAFETY-BOX-XL-K	1860176 (W5014)	universal	2,10 kg	-	150	12

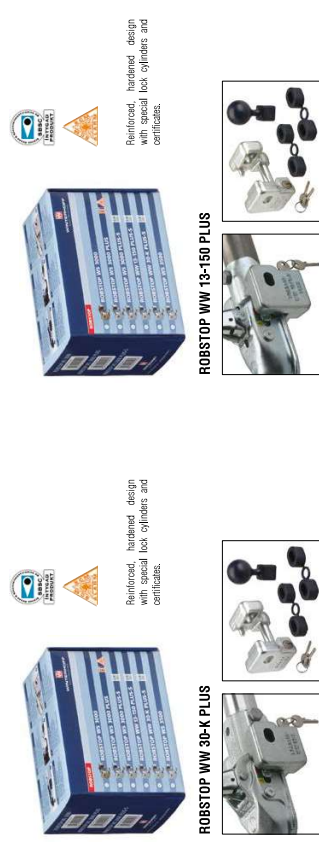

	Order no.	suitable for	Certificates			
ROBSTOP WW 30-K PLUS	1860168 (W1542)	WW 30-K+Z, WW 30-KD50, WW 30-KD51	SCM (NL)	1,82 kg	-	500
ROBSTOP WW 30-K PLUS-S	1860166 (W1529)	WW 30-K+Z, WW 30-KD50, WW 30-KD51	SBSC (S)	1,95 kg	-	500
ROBSTOP WW 13-150 PLUS	1860167 (W1532)	WW 13-N, WW 150-RB, EM 150-RA, EM 150-RB	SCM (NL)	1,82 kg	-	12
ROBSTOP WW 13-150 PLUS-S	1860165 (W1527)	WW 13-N, WW 150-RB, EM 150-RA, EM 150-RB	SBSC (S)	1,95 kg	-	12