

# DRAWBAR WITH OVERRUN HITCH ZAV 2,7-1/3,5-1

ETI- No. 827105-2

(Specify the order with the ETI No.)

47.43.47x.xxx / 47.51.47x.xxx

Spare parts

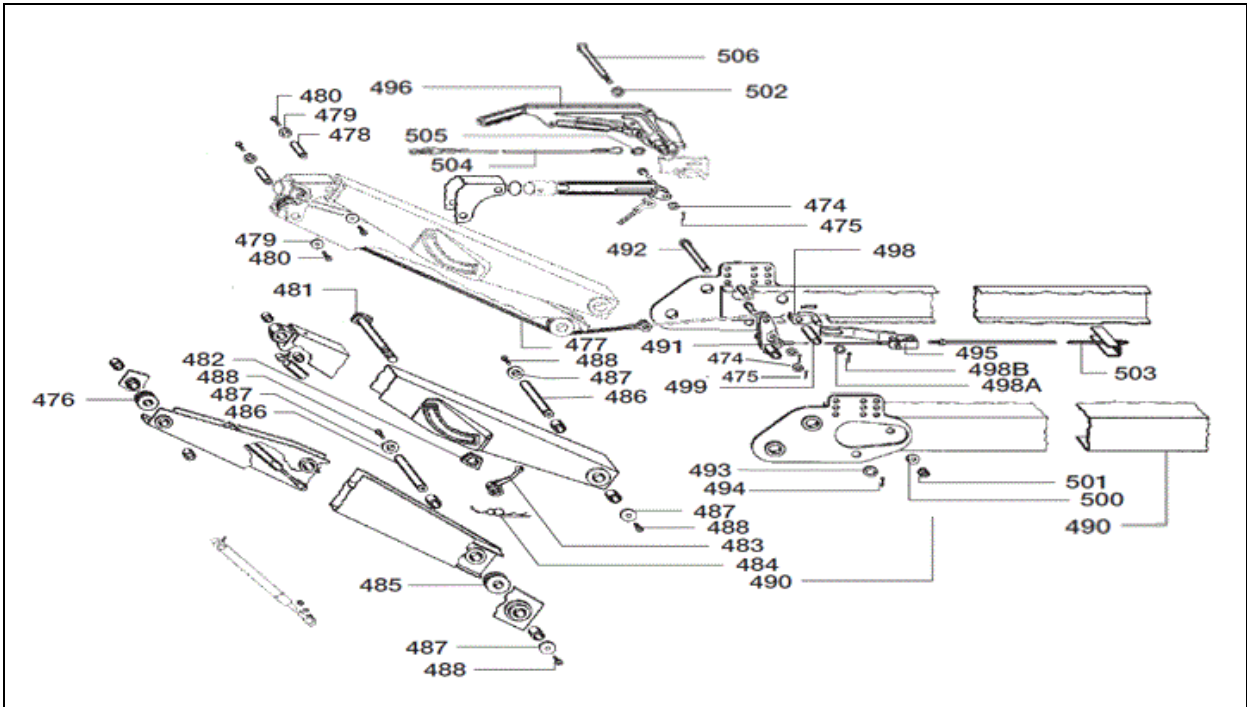

Item	Description	Material-No. (Part-No. BPW- FZT)
474	DISC	706894 02.5401.10.04
475	SPLINT	4018553 02.6201.32.01
476	ROLLER	4008098 05.331.10.23.0
477	CABLE	4018011 05.327.20.14.0
478	BOLT	4015436 03.086.11.08.0
479	DISC	4016958 03.321.11.02.0
480	HEXAGON SCREW	4018376 02.5041.22.91
481	THREAD BOLT WITH TOOTH SEGMENT	4006801 05.177.52.06.0
482	SEGMENT	4017018 03.345.36.07.0
483	LOCKING NUT	4003209 03.265.05.10.0
484	CIRCLIP	4018027 05.350.00.12.0
485	ROLLER COMPLETE	4008099 05.331.10.25.0
486	BOLT	NO MORE AVAILABLE
487	DISC	NO MORE AVAILABLE
488	COUNTERSUNK SCREW	4018376 02.5041.22.91
490	DRAWBAR TUBE	UPON REQUEST
491	REVERSING LEVER (100:32) SEE ORIGINAL PART	4006899 05.190.56.15.0

Item	Description	Material-No. (Part-No. BPW- FZT)
491	REVERSING LEVER (100:35) SEE ORIGINAL PART	4006903 05.190.56.25.0
492	BOLT	4015437 03.086.11.09.0
493	DISC	706899 02.5401.19.04
494	SPLINT	4018557 02.6201.50.01
495	CABLE COMPLETE WITH SHAPED PLATE	NO MORE AVAILABLE
496	HAND BRAKE LEVER	4017521 05.203.10.06.0
498	LEVER (DRIVER)	4016112 03.190.56.01.0
498A	DISC	4018466 02.5450.51.04
498B	SPLINT	4018553 02.6201.32.01
499	TUBE	4016857 03.302.06.10.0
500	DISC	706459 02.5404.13.04
501	LOCKING NUT	705521 02.5220.14.12
502	DISC	706899 02.5401.19.04
503	ZUGSTANGEN-GRUPPE	UPON REQUEST
504	CABLE	4018009 05.327.20.09.0
505	SAFTY RING	4016905 03.310.70.09.0
506	THREAD BOLT	4016028 03.177.52.07.0

provided	ETI-No.	changed	Change No.	Reason of the change	Revisions-No.
05.04.18 P.S.	827105-2_en				