





# FRENO A REPULSIONE V

1.500 - 2.700 kg



**SAP:** AE KPL V OB 251S AK270 GASF

**AE V 251S con AK 270 e Soft-Dock**

Cod. art.	Tipo	Portata complessiva in kg	Carico d'appoggio in kg	Attacco carcassa repulsore	Leva di rinvio reversibile?	Combinabile con freno ruota AL-KO	Gancio montato				
1 251 916	251S	1.500-2.700	120	sopra	sì	1637/2051	AK 270	14	-	40	2
1 251 917	251S	1.500-2.700	120	sopra	sì	2361	AK 270	14	-	40	20
1 251 918	251S	1.500-2.700	120	sopra	sì	3062/3081	AK 270	14	-	40	20

3

**N. verbale di approvazione ECE**

Freno a repulsione: 361-0044-97



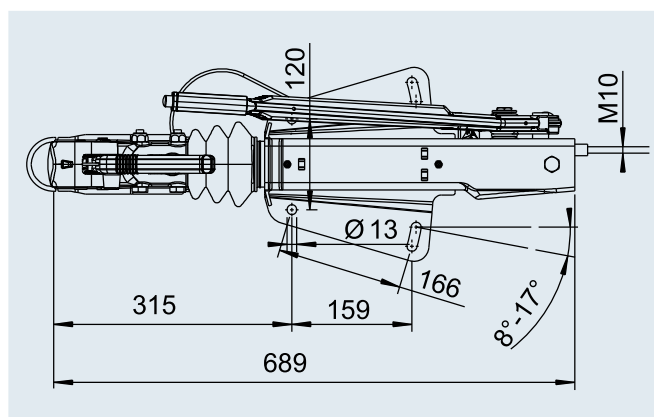

**N. approvazione ECE**

Carcassa repulsore: E1 55R-01 0227



**SAP:** AE KPL V UN 251S AK270 GASF

**AE V 251S con AK 270 e Soft-Dock**

Cod. art.	Tipo	Portata complessiva in kg	Carico d'appoggio in kg	Attacco carcassa repulsore	Leva di rinvio reversibile?	Combinabile con freno ruota AL-KO	Gancio montato				
1 251 919	251S	1.500-2.700	120	sotto	sì	1637/2051	AK 270	14	-	40	2
1 251 920	251S	1.500-2.700	120	sotto	sì	2361	AK 270	14	-	40	20
1 251 921	251S	1.500-2.700	120	sotto	sì	3062/3081	AK 270	14	-	40	20

**N. verbale di approvazione ECE**

Freno a repulsione: 361-0044-97

**N. approvazione ECE**

Carcassa repulsore: E1 55R-01 0227

