





FRENO A REPULSIONE V

950 - 1.600 kg



SAP: AE KPL V UN 161S AK161 GASF

AE V 161S con AK 161 e Soft-Dock

Cod. art.	Tipo	Portata complessiva in kg	Carico d'appoggio in kg	Attacco carcassa repulsore	Leva di rinvio reversibile?	Combinabile con freno ruota AL-KO	Gancio montato				
1 251 914	161 S	950-1.600	100	sotto	no	1637/2051	AK 161	12	-	20	2
1 251 915	161 S	950-1.600	100	sotto	no	2361	AK 161	12	-	20	2

N. verbale di approvazione ECE

Freno a repulsione: 361-0047-97



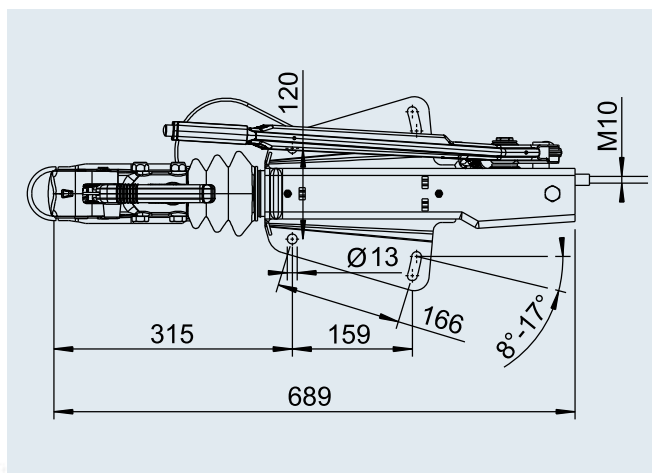

N. approvazione ECE

Carcassa repulsore: E1 55R-01 0229



SAP: AE KPL V OB 161S DINÖSE GASF

AE V 161S con golfare DIN

Cod. art.	Tipo	Portata complessiva in kg	Carico d'appoggio in kg	Attacco carcassa repulsore	Leva di rinvio reversibile?	Combinabile con freno ruota AL-KO	Gancio montato				
299 319	161 S	950-1.600	100	sopra	no	1637/2051	golfare DIN	14	-	40	2
242 935	161 S	950-1.600	100	sopra	no	2361	golfare DIN	14	-	40	2

N. verbale di approvazione ECE

Freno a repulsione: 361-0047-97

N. approvazione ECE

Carcassa repulsore: E1 55R-01 0229

