

WHEEL BRAKE 1637 WD FLUSHING SYSTEM

ETI- No. 811526

(Specify the order with the ETI No.)

AL-KO
Spare Parts

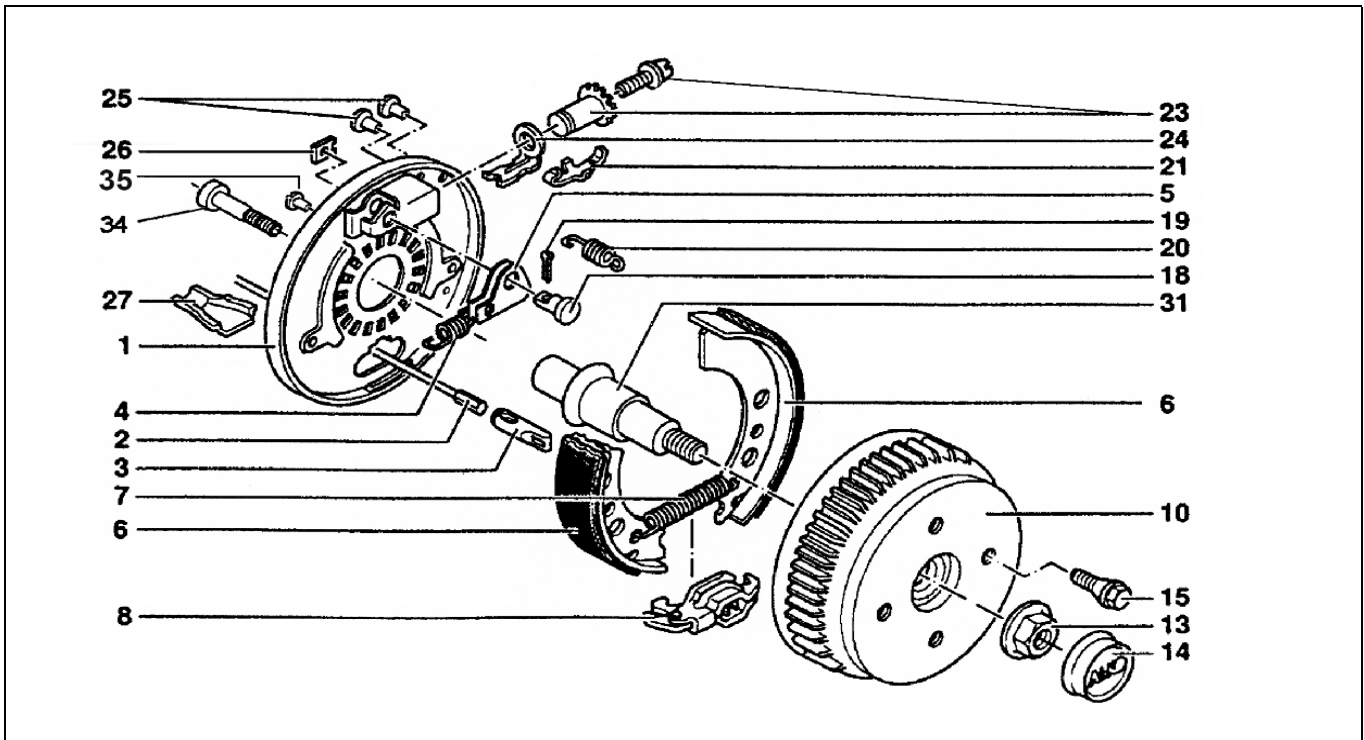

Item	Description	Drawing No.
1	BRAKING PLATE WELDED LEFT	1362874
1	BRAKING PLATE WELDED RIGHT	1362875
2	BOWDEN CABLE 350/ 546	247281
2	BOWDEN CABLE 530/ 726	247282
2	BOWDEN CABLE 770/ 966	247283
2	BOWDEN CABLE 890/1086	247284
2	BOWDEN CABLE 1020/1216	247285
2	BOWDEN CABLE 1130/1326	247286
2	BOWDEN CABLE 1320/1516	247287
2	BOWDEN CABLE 1430/1626	247288
2	BOWDEN CABLE 1620/1816	247289
2	BOWDEN CABLE 1790/1986	247290
3	CONNECTION EYE	604262
4	TENSION SPRING LEFT	2188870001
4	TENSION SPRING RIGHT	372805
5	AUTO-REVERSE LEVER LEFT	384308
5	AUTO-REVERSE LEVER RIGHT	384309
6	SET BRAKE JAW	1213888
7	TENSION SPRING	2182150003
8	SPREAD LOCK	570666
10	BREAK DRUM 98X4 CPL	623748
	BREAK DRUM 100X4 CPL	623749
	BREAK DRUM 112X5 CPL	623750
	ET-SET: BEARING-CIRCLIP-FLANGE NUT	1224800
13	FLANGE NUT M24X1,5	581200

Item	Description	Drawing No.
14	END CAP	581197
15	WHEEL BOLT CONUS M12X1,5	2081670018
15	WHEEL BOLT BALL M12X1,5	2081670020
15	WHEEL BOLT BALL M12X1,5 (R13)	372138
18	BEARING BOLT	368651
19	SPLINT 4X20 DIN94	700192
20	COMPRESSION SPRING	2088800003
21	FLAT SPRING	581879
23	ADJUSTING BOLT AND ADJUSTING NUT	21873708
24	COMPRESSION BINDER	581878
25	STOPPER	373245
26	COVER PLATE	2382610002
27	BOWL	371387
31	STUB AXLE	605566
34	BOLT CYLINDER M20X60	704096
35	STOPPER	691945

The retail sale of brake jaws is not permissible by EU Directive from 01.Oct 2002!

Attention: POS 7, 20 and 26 oddly orderable or in set brake jaw 1213888 contained.

provided	ETI-No.	changed	Change No.	Reason of the change	Revisions-No.
20.06.07	811526_en	07.07.2009	FREIGABE		A
		16.02.2011 HI	16422	SEE CHANGE NOTICE	B