

AL-KO AAA PREMIUM BRAKE

The high-performance brake

THE PREMIUM BRAKE THAT ADJUSTS AUTOMATICALLY

- || Suitable for AL-KO wheel brakes, and thus for most trailers with AL-KO axles
- || The proven wheel brakes with their braking values far above the average are supplemented by the automatic adjustment function
- || When driving in reverse, adjustment is deactivated to prevent the brake from locking up
- || Easy changeover to the latest technology via a pre-assembled system (AL-KO screw system)



BRAKING DISTANCE IS TIME

As soon as the brake has excess play, the AAA automatically readjusts. This means the brake system is always optimally adjusted, so you save valuable braking distance in a dangerous situation.

E.g. car with caravan perm. gross weight 1,500 kg:



Braking from 100 km/h
with poorly adjusted brake
system: 79 m

Braking from 100 km/h with optimally
adjusted brake system: 74 m
= 5 m shorter braking distance = 1 vehicle length!

Braking distance 79 m

AL-KO AAA

Braking distance 74 m

THE ADVANTAGES FOR YOU



- || **Greater driving safety** by a braking distance up to 5 m shorter
- || **Greater ride comfort** through smooth braking without jolting when setting off
- || **Lower maintenance costs due to extended service intervals and dispensing with the first workshop visit after 1000 km**
- || No renewed presentation to TÜV required following installation
- || **Tip:** Change over to the AAA Premium Brake the next time you change your brake pads, if not before

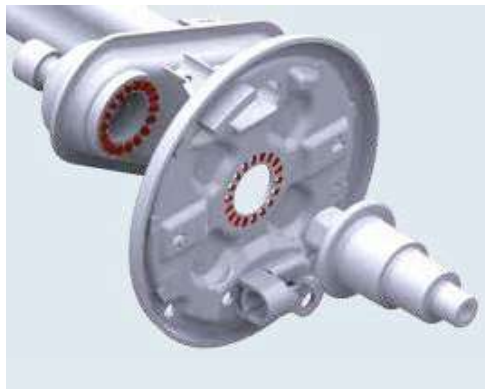

SCOPE OF DELIVERY



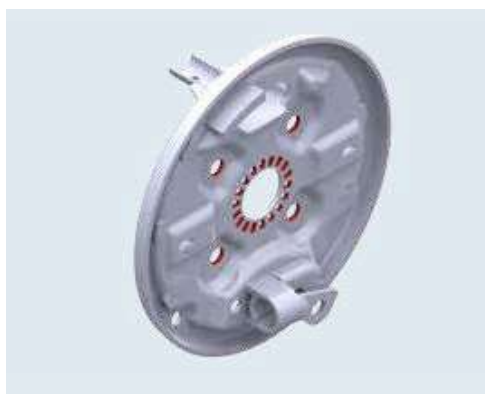

Retrofit set AAA for wheel brake 2051 version with toothed profile

Part no.	1 730 026
SAP	UMRÜSTSET RB 2051 AAA
can be used with	Wheel brake 2051 from year of manufacture 1999 version with toothed profile
	7.6 kg
 	— 36 units





Retrofit set AAA for wheel brake 2051 version with toothed profile with 4 holes

Part no.	1 730 255
SAP	UMRÜSTSET RB 2051 4-LOCH AAA
can be used with	Wheel brake 2051 from year of manufacture 1999 version with toothed profile with 4 holes
	7.6 kg
 	— 36 units





Retrofit set AAA for wheel brake 2361 version with toothed profile

Part no.	1 730 298
SAP	UMRÜSTSET RB 2361 AAA
can be used with	Wheel brake 2361 from year of manufacture 1999 version with toothed profile
	10.4 kg
 	— 36 units



Retrofit set AAA for wheel brake 2361 version with toothed profile with 4 holes

Part no.	1 730 299
SAP	UMRÜSTSET RB 2361 4-LOCH AAA
can be used with	Wheel brake 2361 from year of manufacture 1999 version with toothed profile with 4 holes
	10.4 kg
 	— 36 units