

# WHEEL BRAKE 2051 Ab WD FLUSHING SYSTEM

ETI- No. 811529

(Specify the order with the ETI No.)

**AL-KO**  
Spare Parts

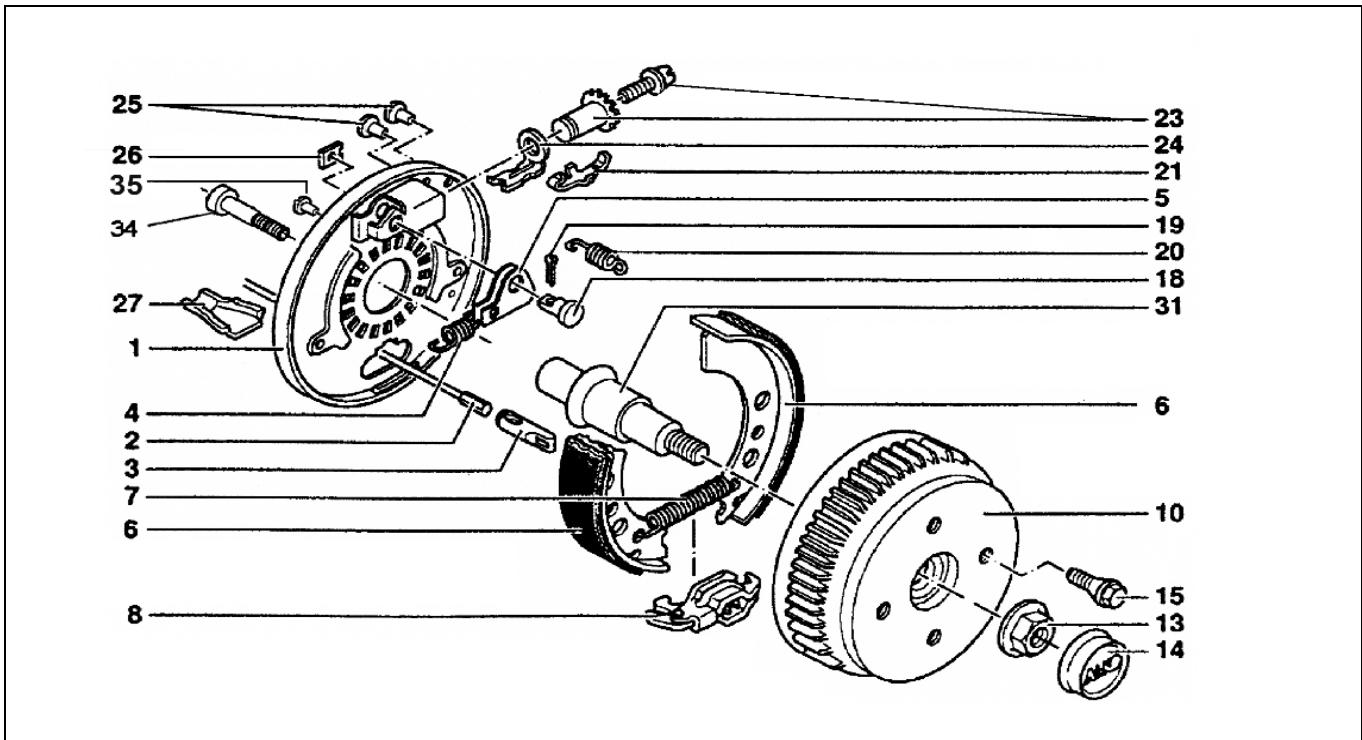

Item	Description	Drawing No.
1	BRAKING PLATE WELDED LEFT	692560
1	BRAKING PLATE WELDED RIGHT	692561
2	BOWDEN CABLE 350/ 546	247281
2	BOWDEN CABLE 530/ 726	247282
2	BOWDEN CABLE 770/ 966	247283
2	BOWDEN CABLE 890/1086	247284
2	BOWDEN CABLE 1020/1216	247285
2	BOWDEN CABLE 1130/1326	247286
2	BOWDEN CABLE 1320/1516	247287
2	BOWDEN CABLE 1430/1626	247288
2	BOWDEN CABLE 1620/1816	247289
2	BOWDEN CABLE 1790/1986	247290
3	CONNECTION EYE	604262
4	TENSION SPRING	2187370003
5	AUTO-REVERSE LEVER LEFT	571386
5	AUTO-REVERSE LEVER RIGHT	571387
6	SET BRAKE JAW	1213889
7	TENSION SPRING	2082000007
8	SPREAD LOCK	571510
10	BREAK DRUM CPL	1312671
	ET-SET: BEARING-CIRCLIP-FLANGE NUT	1224804
13	FLANGE NUT M24X1,5	581200
14	END CAP	1313924
15	WHEEL BOLT CONUS M12X1,5	2081670018
15	WHEEL BOLT BALL M12X1,5	2081670020

Item	Description	Drawing No.
15	WHEEL BOLT BALL M12X1,5 (R13)	372138
18	BEARING BOLT	368651
19	SPLINT 4X20 DIN94	700192
20	COMPRESSION SPRING	2088800003
21	FLAT SPRING	368405
23	ADJUSTING BOLT AND ADJUSTING NUT	21873708
24	COMPRESSION BINDER	368361
25	STOPPER	373245
26	COVER PLATE	2382610002
27	BOWL	371387
31	STUB AXLE	605495
34	BOLT CYLINDER M20X60	704096
35	STOPPER	691945

The retail sale of brake jaws is not permissible by EU Directive from 01.Oct 2002!

Attention: POS 7, 20 and 26 oddly orderable or in set brake jaw 1213889 contained.

provided	ETI-No.	changed	Change No.	Reason of the change	Revisions-No.
24.07.07	811529_en	06.07.2009	FREIGABE		A
		16.02.2011 HI	16422	SEE CHANGE NOTICE	B