

WHEEL BRAKE 1636 G AR

ETI- No. 811305

(Specify the order with the ETI No.)

AL-KO

Spare Parts

VERSION A: ROCKER WITH CROSS HOLE BORE, CASTELLATED NUT AND SPLINT

VERSION B: ROCKER WITH TRENCH AND LOCK NUT

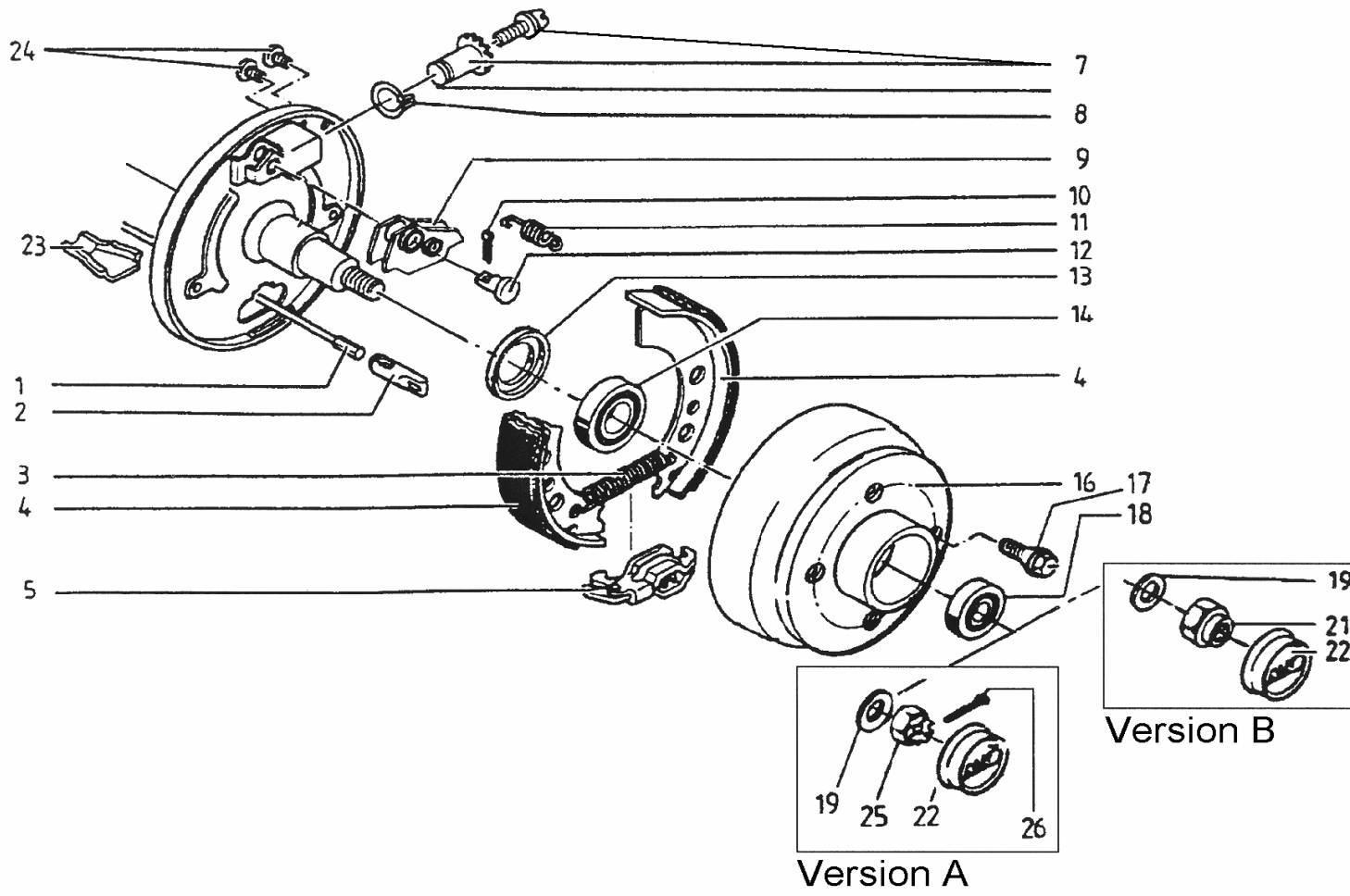

Item	Description	Drawing No.
1	BOWDEN CABLE	350 247281
		530 247282
		770 247283
		890 247284
		1020 247285
		1130 247286
		1320 247287
		1430 247288
		1620 247289
		1790 247290
2	CONNECTION EYE	604262
3	TENSION SPRING	2182150003
4	BRAKE JAW	384481
5	SPREAD LOCK	570666
6	ADJUSTING BOLT AND	
7	ADJUSTING NUT	21873708
8	RING SPRING	606692
9	LOCKING LEVER	386905
10	SPLINT 4x20 DIN 94	700192
11	COMPRESSION SPRING	2088800003
12	BEARING BOLT	368651
13	SHAFT SEALING RIN	701511
14	BEARING CONUS LM 11749/710	701512
15	BRAKE JAW	384296
16	BRAKE DRUM 100x4/M12x1,5	1312140

Item	Description	Drawing No.
17	WHEEL BOLT CONUS M12x1,5 SPHERIC M12x1,5 SPHERIC M12x1,5 (R13)	2081670018
		2081670020
		372138
18	BEARING CONUS LM 45449/410	701513
19	LOCKING WASHER	700625
21	LOCK NUT	1312008
22	COVERING CAP	2381250003
23	BOWL	371387
24	STOPPER	373245
25	CASTELLATED NUT M16x1,5	700754
26	SPLINT Ø 4x30 DIN 94	700194

THE RETAIL SALE OF BRAKE JAWS IS NOT PERMISSIBLE BY EU DIRECTIVE FROM 01. OCT 2002!

ATTENTION: POS 3, 11 ODDLY ORDERABLE OR IN SET BRAKE JAW 1213888 CONTAINED!

ATTENTION: APPLY LOCK NUT ONE TIME ONLY

provided	ETI-No.	changed	Change No.	Reason of the change	Revisions-No.
03.05.00	811305_en	18.02.2010	FREIGABE		A